

For greatest freedom of design and  
functional versatility

# Front Door System heroyal D 72



**heroyal**



## Front Door Systems

First-class materials, technical perfection down to the smallest detail and a wide variety of design options are the unique characteristics of heroal's efficient system technology. Advantages that are convincing. For decades, heroal has been the reliable partner for architects, builders and fabricators, offering innovative solutions for the building shell made from aluminium and aluminium composites.

Planners appreciate the wide range of versatile design options, builders are able to create individual requirements with a reliable system, and our partners benefit from economically efficient heroal system solutions.

The system heroal D 72 offers functional versatility and sophisticated designs, achieves perfect insulation values and meets the highest static requirements. The certified, reliable heroal system is suitable for all standard opening variants, including automatic door systems and burglary resistant front doors - also with emergency exit function.

Explore the variety of the front door systems heroal D 72!



### heroal D 72

Door system offering great flexibility

Page 4

### heroal D 72 RL

Door system with roundline outer contour

Page 5

### heroal D 72 CL

Door system with chamfered outer contour

Page 6

### Door types and opening variants

Page 7

### Sash and design variants

Page 8

### heroal technologies

Page 10

### Threshold solutions

Page 12

### System dimensions and system features

Page 13

### Service

Page 14

## heroal D 72

Door system offering great flexibility



The front door system heroal D 72 offers a great design variety within one system. At the same time, the performance features of this front door system can be adapted to the individual technical requirements of a building. The system covers a unique spectrum of thermal insulation, wind load resistance, air permeability and thresholds. heroal fabricators do not only benefit from this great flexibility, but also from a consistent system logic and enhanced production reliability.

### System dimensions and system features

- » design depth: 72 mm (frame/bars), 65-72 mm (sash)
- » variable face widths: frame 60-250 mm, sash 56-124 mm, bars 70-254 mm
- » smallest combinable face width: 145 mm
- » max. sash width/ height: 1,400 mm/ 3,000 mm
- » max. sash weight: 180 kg
- » max. thickness of glass /infill panel: frame up to 54 mm, sash up to 68 mm (glass) and 72 mm (panel)
- » thermal insulation:  $U_f > 1.7 \text{ W/m}^2\text{K}$  (meeting all requirements of GEG 2020, the German Buildings Energy Act)
- » air permeability: 4
- » tightness against driving rain: up to E900
- » wind load resistance: C4
- » soundproofing: up to  $R_w = 43 \text{ dB}$
- » certified burglary resistance up to resistance class RC 3
- » impact resistance: class 4
- » operating forces: class 2
- » mechanical strength: class 3
- » continuous function: up to class 8
- » behaviour between different climates: class 2 (d/e)
- » meeting requirements of load bearing capacity of safety devices
- » patented, warp-resistant compound profile

### Design options

- » opening variants: single or multi-part elements with sidelights and toplights
- » single or multi-part formed elements with sidelights or toplight as segmental, round or basket arch
- » design variant heroal D 72 PF „Panel Fixed“ with fixed stop, no glazing strip required
- » all-round sash frame, with base, single or double-sided FüF
- » compatible window system: heroal W 72
- » integration into curtain wall system heroal C 50 HI possible (entrance curtain walls)
- » high-quality colour design with heroal hwr powder coating, heroal SD surface designs and Les Couleurs® Le Corbusier

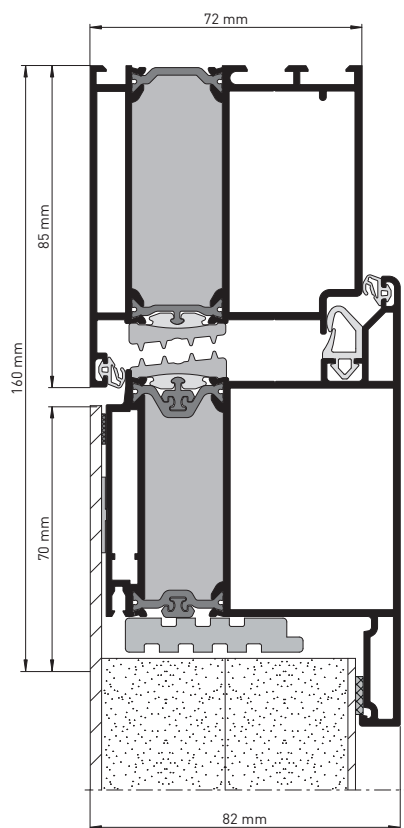

heroal D 72, cross section

## heroal D 72 RL

Door system with roundline outer contour

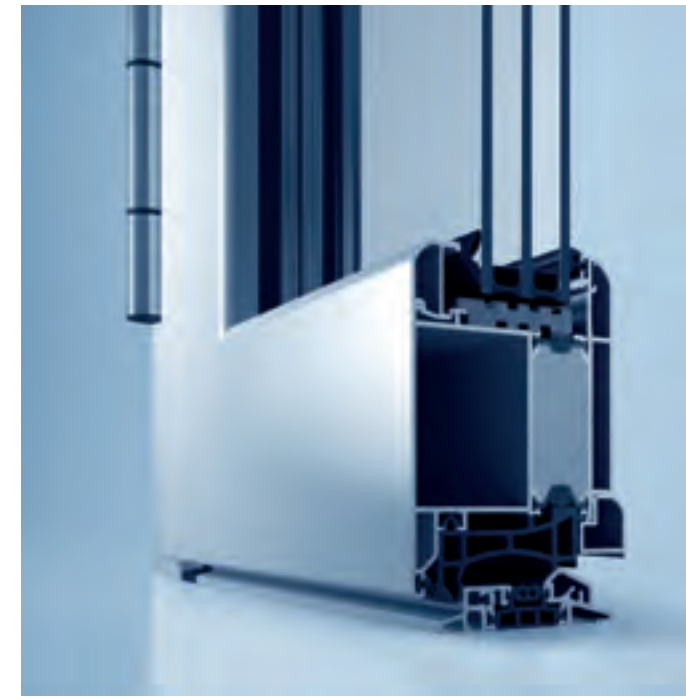

The front door system heroal D 72 RL stands out for its harmonious roundline contour. The rounded outer contour ideally matches the style of old or listed buildings, which makes this system perfectly suited for restoration projects. heroal D 72 RL offers the same excellent performance features as the front door system heroal D 72.

### System dimensions and system features

- » design depth: 72 mm (frame/bars), 65-72 mm (sash)
- » variable face widths: frame 60-250 mm, sash 56-124 mm, bars 70-254 mm
- » smallest combinable face width: 145 mm
- » max. sash width/ height: 1,400 mm/ 3,000 mm
- » max. sash weight: 180 kg
- » max. thickness of glass /infill panel: frame up to 54 mm, sash up to 68 mm (glass) and 72 mm (panel)
- » thermal insulation:  $U_f > 1.7 \text{ W/m}^2\text{K}$  (meeting all requirements of GEG 2020, the German Buildings Energy Act)
- » air permeability: 4
- » tightness against driving rain: up to E900
- » wind load resistance: C4
- » soundproofing: up to  $R_w = 43 \text{ dB}$
- » certified burglary resistance up to resistance class RC 3
- » impact resistance: class 4
- » operating forces: class 2
- » mechanical strength: class 3
- » continuous function: up to class 8
- » behaviour between different climates: class 2 (d/e)
- » meeting requirements of load bearing capacity of safety devices
- » patented, warp-resistant compound profile

### Design options

- » opening variants: single or multi-part elements with sidelights and toplights
- » single or multi-part formed elements with sidelights or toplight as segmental, round or basket arch
- » design variant heroal D 72 PF „Panel Fixed“ with fixed stop, no glazing strip required
- » all-round sash frame, with base, single or double-sided FüF
- » front door system compatible with profile: heroal D 72
- » compatible window system: heroal W 72 RL
- » integration into curtain wall system heroal C 50 HI possible (entrance curtain walls)
- » high-quality colour design with heroal hwr powder coating, heroal SD surface designs and Les Couleurs® Le Corbusier

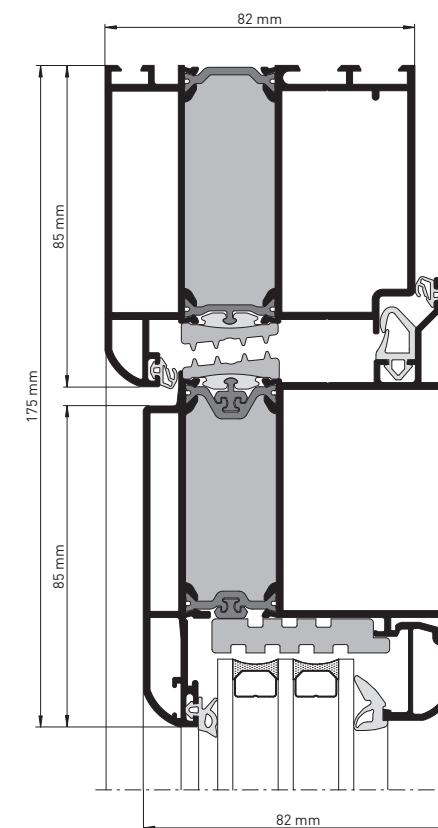

heroal D 72 RL, cross section



# heroal D 72 CL

Door system with chamfered outer contour

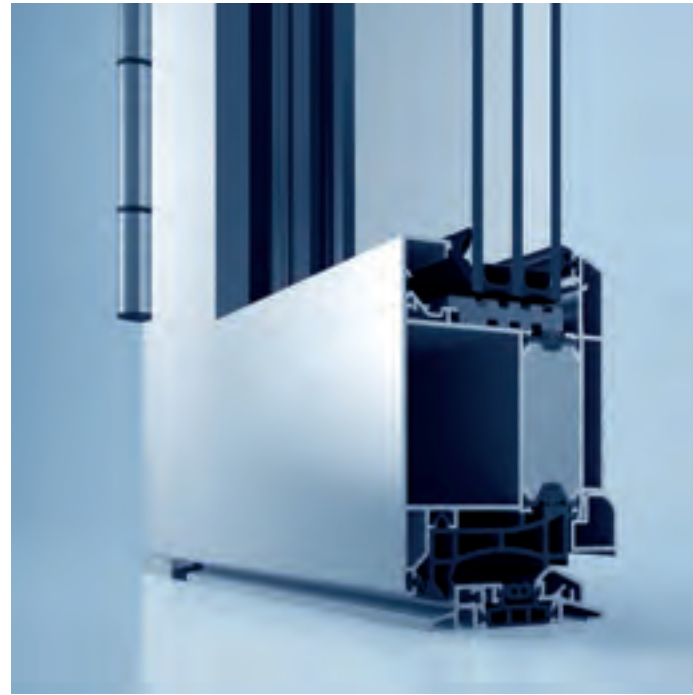

The front door system heroal D 72 CL captivates with its elegant classicline contour. The chamfered outer contour is the ideal solution for buildings in a classical style. heroal D 72 CL offers the same excellent performance features as the front door system heroal D 72.

### System dimensions and system features

- » design depth: 72 mm (frame/bars), 65-72 mm (sash)
- » variable face widths: frame 60-250 mm, sash 56-124 mm, bars 70-254 mm
- » smallest combinable face width: 145 mm
- » max. sash width/ height: 1,400 mm/3,000 mm
- » max. sash weight: 180 kg
- » max. thickness of glass/infill panel: frame up to 54 mm, sash up to 68 mm (glass) and 72 mm (panel)
- » thermal insulation:  $U_f > 1.7 \text{ W/m}^2\text{K}$  (meeting all requirements of GEG 2020, the German Buildings Energy Act)
- » air permeability: 4
- » tightness against driving rain: up to E900
- » wind load resistance: C4
- » soundproofing: up to  $R_w = 43 \text{ dB}$
- » certified burglary resistance up to resistance class RC 3
- » impact resistance: class 4
- » operating forces: class 2
- » mechanical strength: class 3
- » continuous function: up to class 8
- » behaviour between different climates: class 2 (d/e)
- » meeting requirements of load bearing capacity of safety devices
- » patented, warp-resistant compound profile

### Design options

- » opening variants: single or multi-part elements with sidelights and toplights
- » single or multi-part formed elements with sidelights or toplight as segmental, round or basket arch
- » design variant heroal D 72 PF „Panel Fixed“ with fixed stop, no glazing strip required
- » all-round sash frame, with base, single or double-sided FÜF
- » front door system compatible with profile: heroal D 72
- » compatible window system: heroal W 72 RL
- » integration into curtain wall system heroal C 50 HI possible (entrance curtain walls)
- » high-quality colour design with heroal hwr powder coating, heroal SD surface designs and Les Couleurs® Le Corbusier

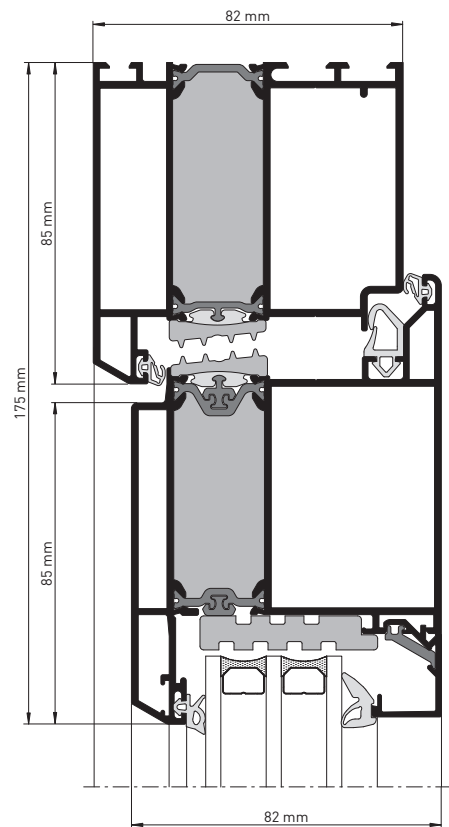

heroal D 72 CL, cross section

# Door types and opening variants

Flexible designs for all requirements

### Single sash elements with sidelights and toplights

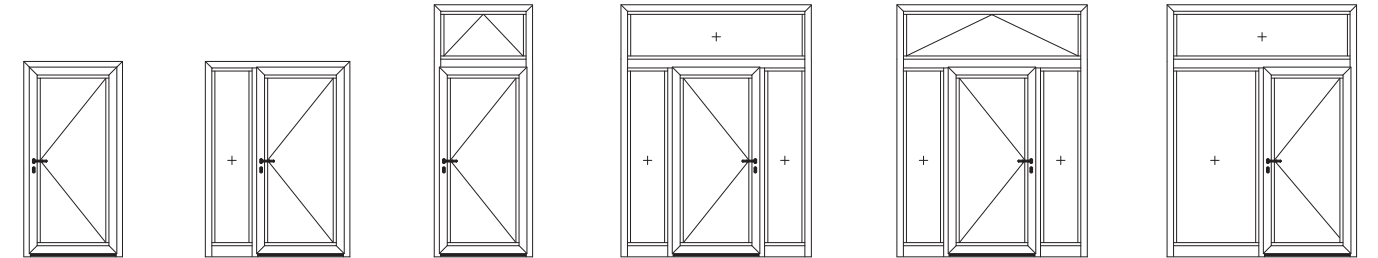

### Double sash elements with sidelights and toplights

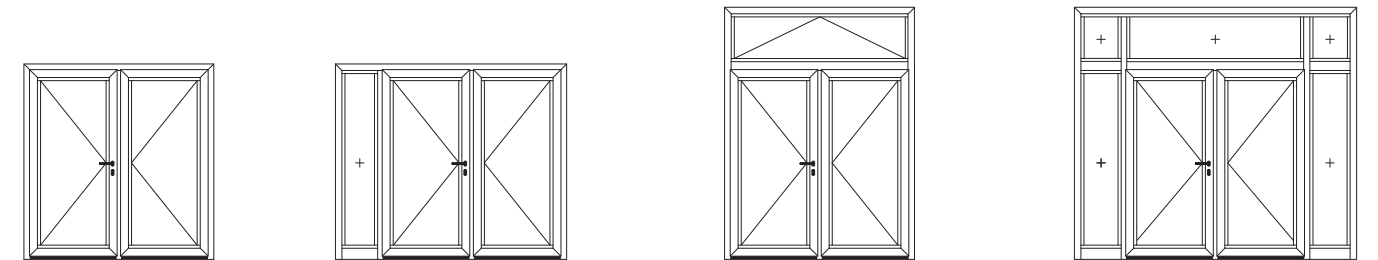

### Special forms with one or two sashes

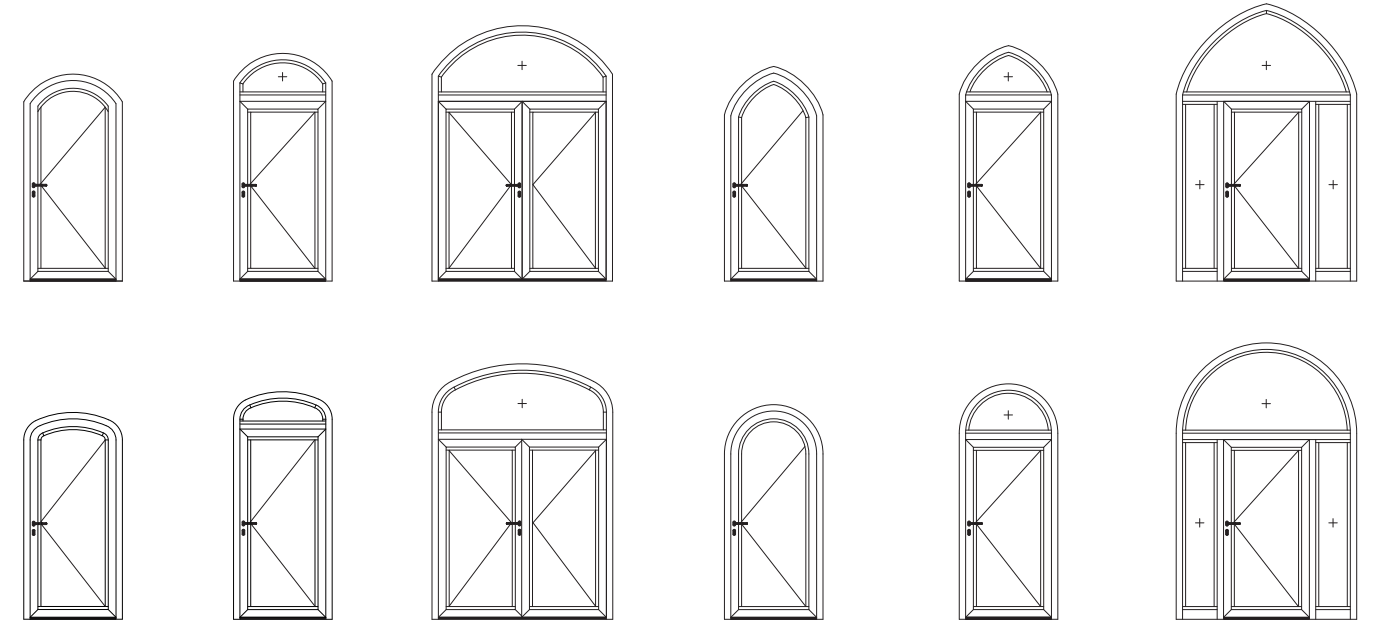

## Sash and design variants

### Wide range of variants

The wide range of design options and an extremely efficient production are two of the major characteristics of the front door system heroal D 72. Sash profiles for infill panels, single or double-sided sash-concealing panels, as well as sash-concealing panels for door elements with two sashes provide for the manufacture of a wide variety of designs. heroal further extends this freedom of design for its premium segment with heroal D 72

PF (Panel Fixed) sash profiles, which offer a fixed inside stop instead of a glazing strip, and sash profiles for 6 mm motif panels. Also, it is possible to design all sash-concealing panels as a flush or recessed variant. The innovative, certified attachment technology with reversible panel attachment grants even more freedom of design, and helps to save time.

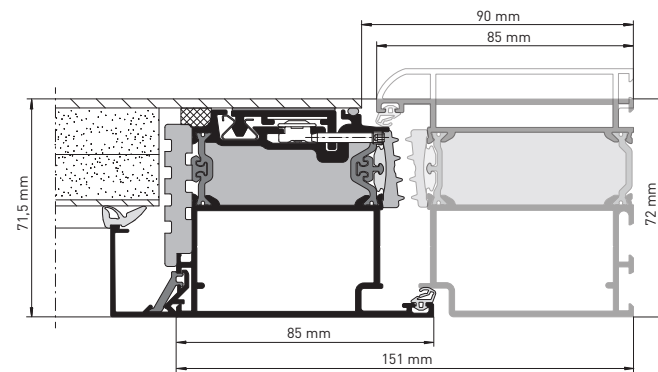

single-sided sash-concealing, reversible

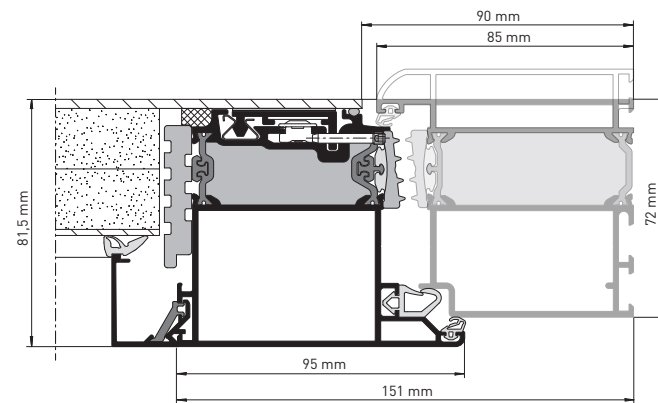

single-sided sash-concealing, reversible

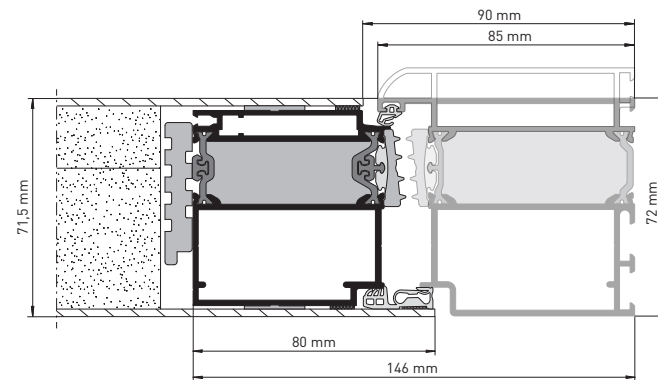

double-sided sash-concealing



### Sash without glazing strip

The wide variety of designs is further extended with the sash profiles heroal D 72 PF (Panel Fixed) for one-sided sash-concealing panels. heroal D 72 PF profiles have a fixed stop and do not require a glazing strip. This reduces the material input and also saves time, resulting in shorter lead times in manufacture. As an option, heroal offers all sash-concealing panel variants, whether for outside or inside applications, with a flush or recessed design.

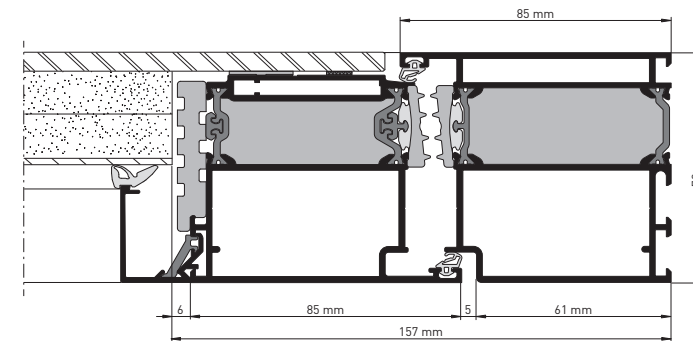

### Sashes for motif panels

The design options for front door panels are unlimited: glass, glazed inserts, aluminium panels or motif panels in countless colours and designs are available. heroal also offers suitable, modern aluminium sash profiles for authentic front door panels made from matured timber or panels with a hard-wearing ceramic surface.

## heroal technologies

For optimised and time-saving manufacture



### heroal corner angle technology

The innovative heroal sealant injection ensures the optimal sealing of the mitre joints of the elements, while requiring only low material input. At all four sides, the corner connectors are completely covered with sealant, providing for even more system reliability. An efficient and time-saving manufacture of doors is made possible through heroal's corner connector technology, which enhances the production process during the installation of the corner angles. The perfectly guided distribution of sealant and the innovative corner angle geometries lead to considerable material savings. heroal expandable corner angles support the alignment of mitre-cut aluminium profiles, so that the manufacture and processing of doors is made easy and fast, without the need for any additional realignments.



### heroal fitting technology

The fitting technology heroal DF ensures a great flexibility, since it is based on a universal design concept that can be adapted to the individual requirements of the user at any time. It also stands out for its intuitive operation and easy usability. heroal door fittings are compatible with sophisticated techniques, such as keyless entry and Bluetooth, which further increase the ease of use. The high-quality, aesthetically appealing hinge technology offers a wide range of barrel and surface hinges, and also a concealed solution.



### heroal T-connector technology

The optimised and time-saving production of doors is made possible by heroal's T-connector technology. The innovative heroal sealant injection has been developed for an optimal sealing of T-connections and joints. The use of closed-cell foam rubber to seal the rebate ensures high system reliability. The innovative heroal sealant injection stands for perfectly sealed T-connectors and joints, requiring only low material input.



### Reversible panel attachment

For its front door system heroal D 72, heroal offers a reversible panel attachment - an innovation in the aluminium sector. This way of attaching the panel to the sash is made by way of joining and has received RC 2 and RC 3 certification. The reversible panel attachment is suitable for the sash profiles heroal D 72, heroal D 72 CL, heroal D 72 RL and heroal D 72 PF. This way of attaching the panel to the sash, without the need of any bonding technique using 2K adhesives, saves time and makes the fabrication easier and more process reliable. At the same time, fabricators benefit from shorter lead times.



### heroal compound technology

By means of three innovative production steps, the front door system heroal D 72 offers effective protection against the bimetal effect, which might cause warping of the sash frame due to considerable differences in temperature between the inside and outside. The patented, warp-resistant heroal profile compound, consisting of an inserted, tight insulating strip and a slide-in spring, protects the profile against potentially damaging shear forces.

## Threshold solutions

For all requirements and uses

Perfection down to the detail: heroal offers an industry leading variety of threshold solutions meeting all standard requirements. All technical requirements and demands on design can be met, independent of opening type, inward or outward opening, with all-round sash frame or base profile. Furthermore, a wide range of base and connecting profiles allows for an easy integration into the building structure of both new and renovated buildings. The flexible heroal flat threshold with its continuous threshold design makes the creation of barrier-free solutions acc. to DIN

18040-2 possible. It is also possible to add an integrated drainage system (heroal DS) to barrier-free thresholds and zero-barriers (which are also eligible for subsidies granted by the German state-owned development bank KfW). The retractable floor seal in combination with either one or two brush seals guarantees perfect tightness. A classic front door solution for elements with one or more sashes includes a screwed threshold with two sealing sections.

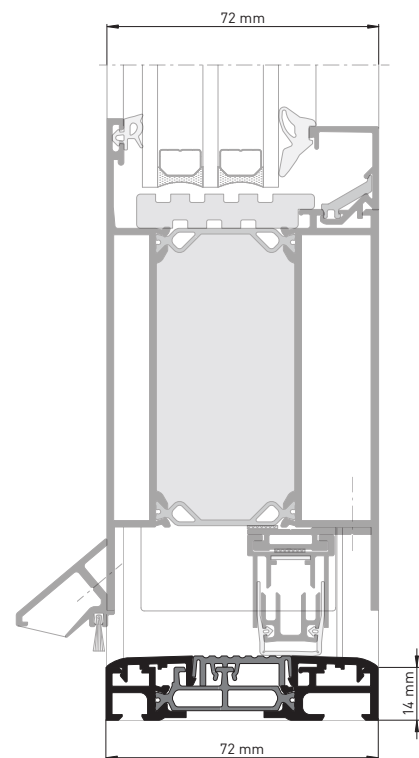

flat threshold with retractable floor seal

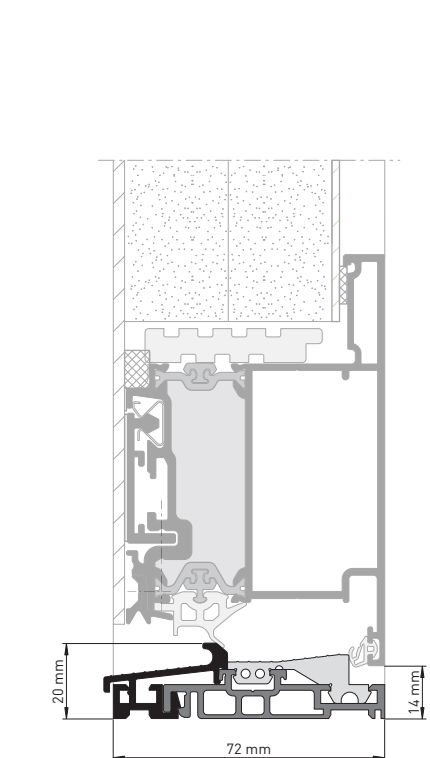

continuous threshold, 2-parts

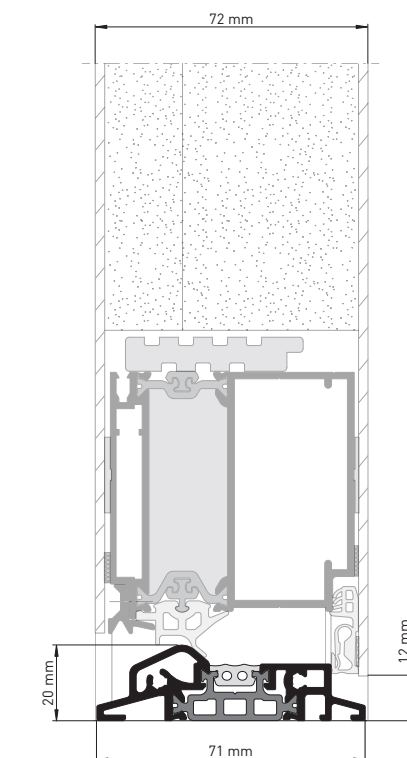

threshold with stop seal

## System dimensions and system features

### System dimensions

Description		heroal D 72	heroal D 72 RL	heroal D 72 CL
Profile design depth (mm)	Frame profiles	72	72-82	82
	Sash profiles	65-72	59-82	59-82
	Bar profiles	72	72-82	72-82
Profil face width (mm)	Frame profiles	60-250	60-154	60-154
	Sash profiles	56-124	56-100	56-85
	Bar profiles	70-254	70-94	74-94
Max. thickness of glass/infill panel (mm)	Frame profiles	54	54	54
	Sash profiles	68/72	68/72	68/72
Max. sash weight (kg)		180	180	180
Max. sash width (mm)		1,400	1,400	1,400
Max. sash height		3,000	3,000	3,000

### System features

Description	heroal D 72	heroal D 72 RL	heroal D 72 CL
Wind load resistance	up to class C4	up to class C4	up to class C4
Tightness against driving rain	up to E 900	up to E 900	up to E 900
Impact resistance	class 4	class 4	class 4
Load bearing capacity of safety devices	requirements met	requirements met	requirements met
Soundproofing	up to $R_w=43$ dB	up to $R_w=43$ dB	up to $R_w=43$ dB
Thermal insulation (Uf in W/m <sup>2</sup> K)	up to 1.7 W/m <sup>2</sup> K	up to 1.7 W/m <sup>2</sup> K	up to 1.7 W/m <sup>2</sup> K
Thermal insulation (UD in W/m <sup>2</sup> K)	up to 1.0 W/m <sup>2</sup> K	up to 1.0 W/m <sup>2</sup> K	up to 1.0 W/m <sup>2</sup> K
Air permeability	up to class 4	up to class 4	up to class 4
Operating forces	class 2	class 2	class 2
Mechanical strength	class 3	class 3	class 3
Continuous function	up to class 8	up to class 8	up to class 8
Behaviour between different climates	class 2 (d/e)	class 2 (d/e)	class 2 (d/e)
Burglary resistance	up to RC 3	up to RC 3	up to RC 3

### Opening variants / door designs

Description	heroal D 72	heroal D 72 RL	heroal D 72 CL	heroal D 72 CL
Barrier-free elements	•	•	•	•
Curtain wall insert elements	•	•	•	•
Compatible heroal window system	heroal W 72	heroal W 72 RL	heroal W 72 CL	heroal W 72 CL
Emergency exits acc. to EN 179/1125 with CE-marking	•	•	-	-



# The heroal all-round service

Support across the entire process chain

## Comprehensive support. Comprehensive satisfaction.

Success is when every cog is perfectly in sync to ensure that everything runs smoothly. So we have designed our service offers to provide optimum support in every aspect of your work. From marketing through to planning and production as well as application, our comprehensive service supports you along the entire process chain.

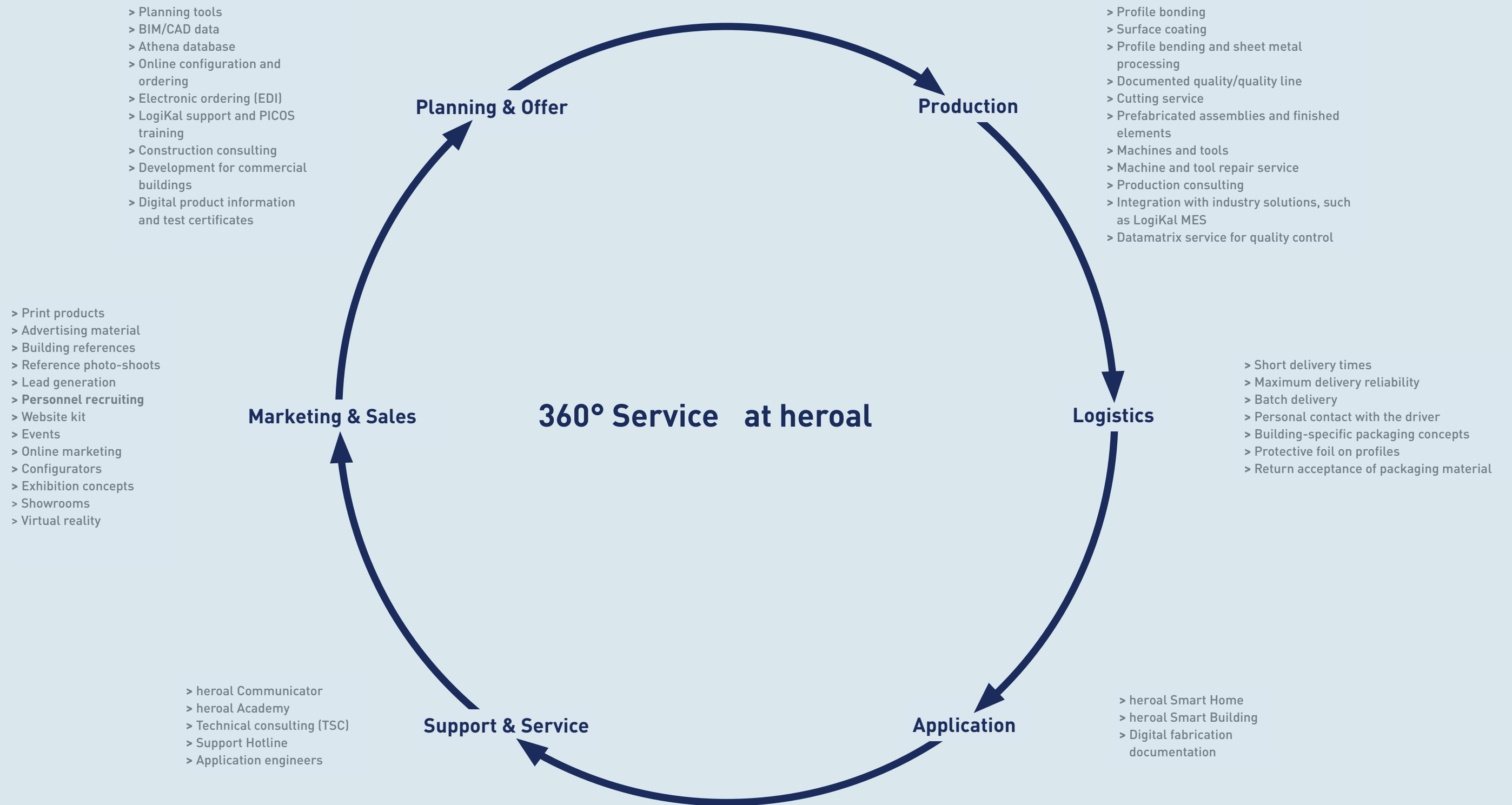



# heroal



## simply better *spaces for life*

As a manufacturer of aluminium system solutions for roller shutters, sun protection, roller doors, windows, doors, sliding doors, curtain walls and patio roofs, heroal is an international market leader, supporting high-quality residential and commercial construction projects worldwide. heroal products are developed and manufactured in Germany and set themselves apart with their premium quality and exceptional performance features. As a result, the innovative system solutions contribute to greater sustainability, security, comfort and architectural freedom for both current and future building projects and impress with simple and efficient planning and fabrication by heroal specialist partners.

Roller shutters | Sun protection | Roller doors

Windows | Doors | Sliding doors | Curtain walls | Patio roofs

**heroal – Johann Henkenjohann GmbH & Co. KG**

Österwieher Str. 80 | 33415 Verl (Germany) | Tel. +49 5246 507-0 | Fax +49 5246 507-222 | [www.heroal.com](http://www.heroal.com)